

ITEM NO.	DESCRIPTION	QTY.
1	KEYSTONE MTG. ADAPTER MTG. SCREWS	6
2	KEYSTONE MTG. ADAPTER (HPW COMPATIBLE)	2
3	SHUTTER SPRING	4
4	SHUTTER	4
5	4-PORT BRITISH STYLE WALL PLATE (BASE)	1
6	CLEAR LABEL FIELD COVER	1
7	1 PORT WALL PLATE COVER W/ HUBBELL LOGO	1
8	M4X25mm COMBO SCREW (NOT SHOWN)	2
9	M3.5X21mm COMBO SCREW (NOT SHOWN)	2

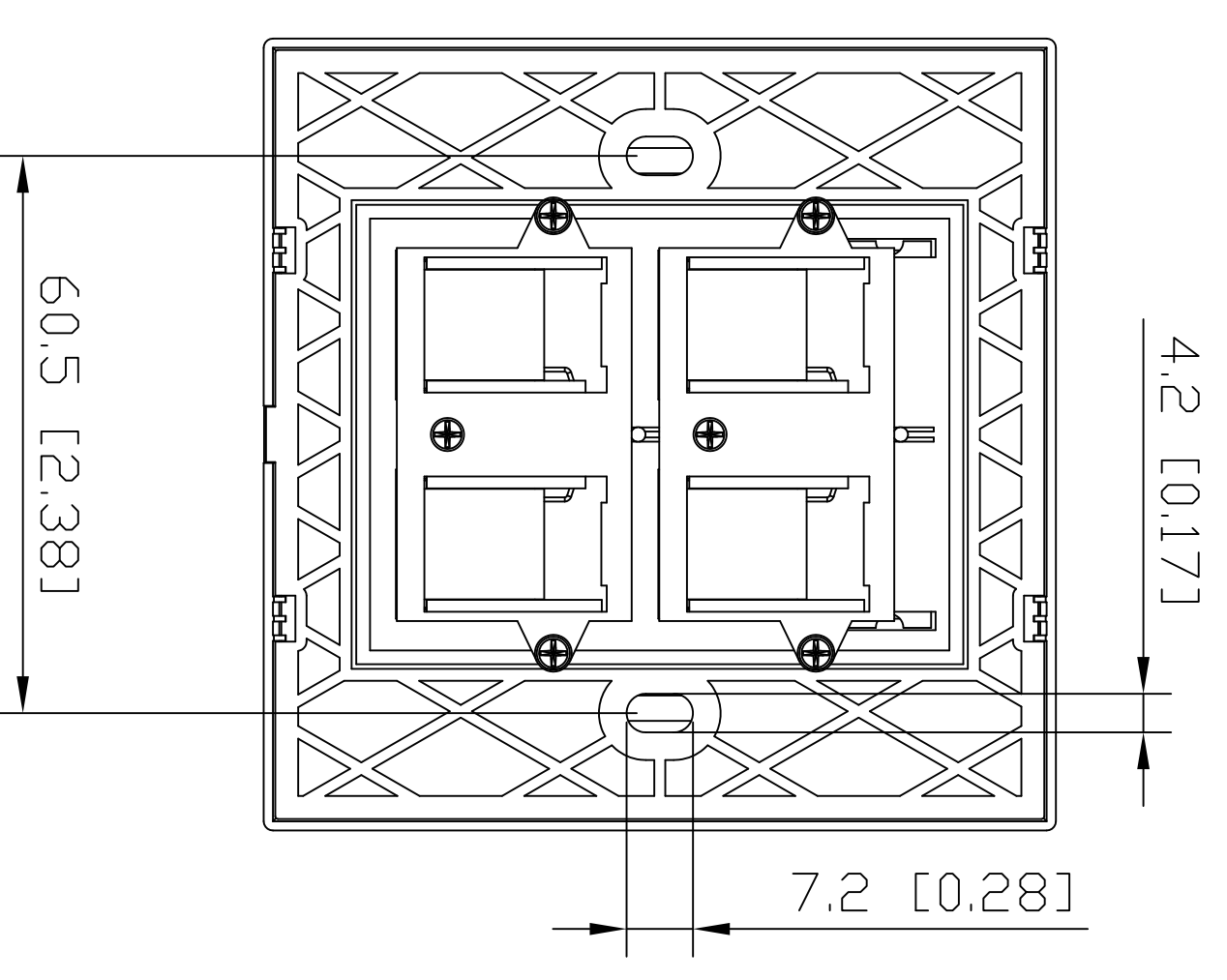
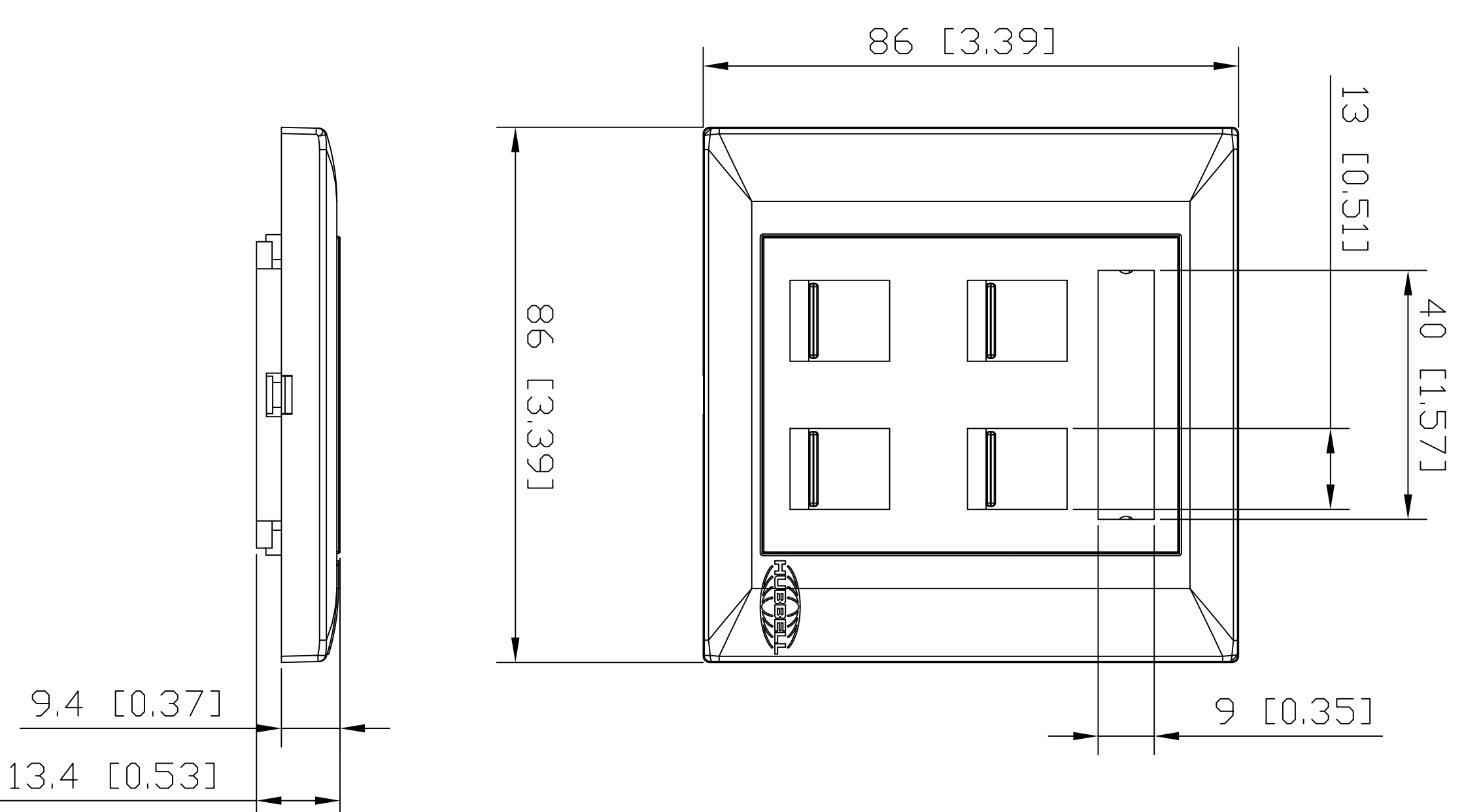
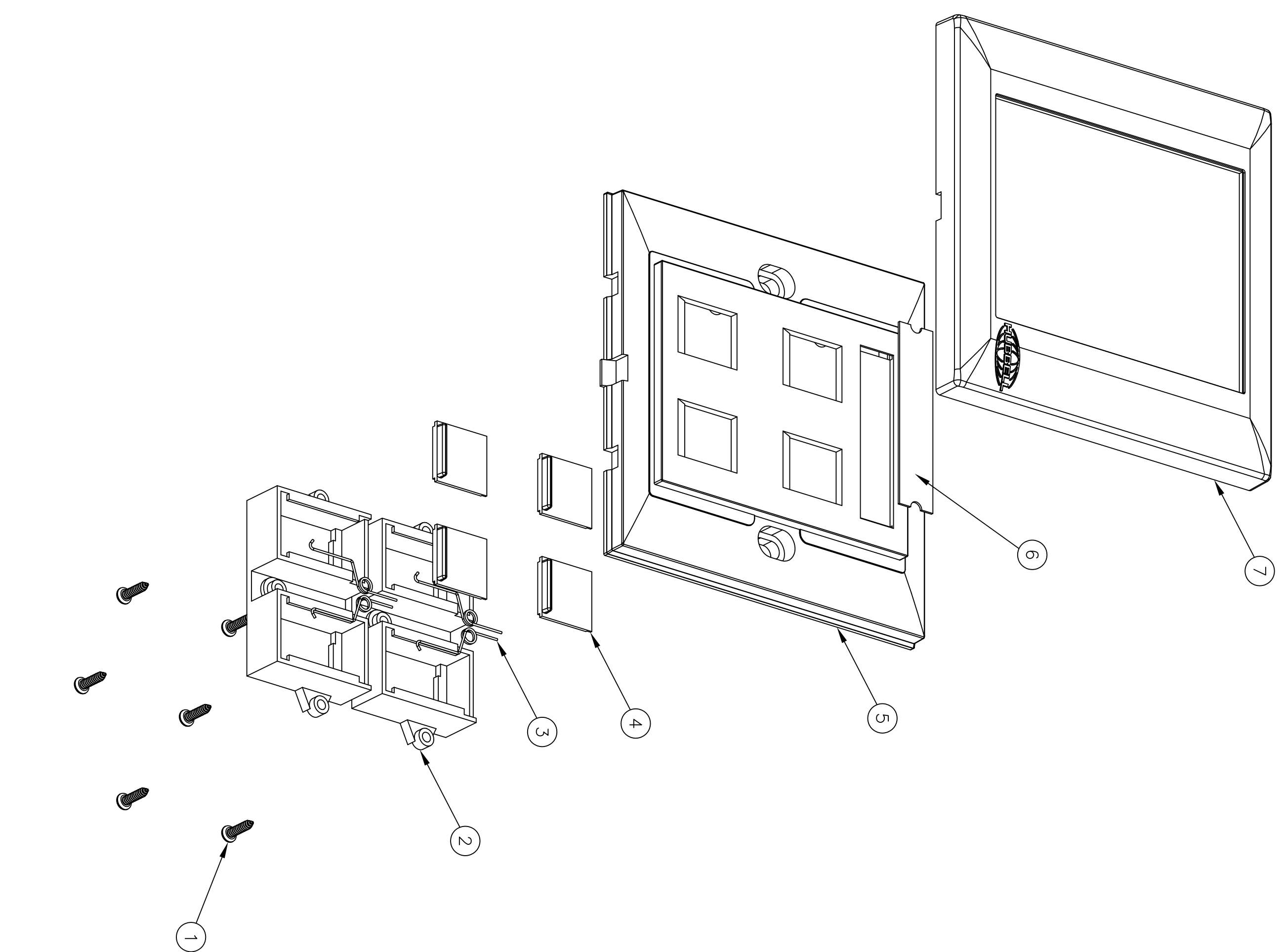

- NOTES:
 1. SPECIFICATIONS SUBJECT TO CHANGE WITHOUT NOTICE.
 2. PLATE COMES FULLY ASSEMBLED.

REV.	ECN	DATE	DESCRIPTION	CHG BY	APPD BY
2	18140	05/14/13	ADDED SCREW CALLOUTS TO TABLE	MMA	

Created on AUTOCAD

DIMENSIONING AND TOLERANCE PER ANSI Y14.5M-1982 UNLESS OTHERWISE SPECIFIED. DIMENSIONS ARE IN INCHES (MM).
 .XX = ±.01 (.25)
 .XXX = ±.005 (.127)
 .XXXX = ±.0025 (.0635)
 ANGLE TOL. ±1°

IN ACCEPTING OUR DRAWINGS, BUYER AGREES TO QUOTE AND ORDER PARTS AND MATERIALS FROM THE SUPPLIER AND TO DISCLOSE TO OTHERS THE IDEAS, INFORMATION, OR DESIGNS SHOWN HEREIN, AND THAT YOU WILL MAKE NO USE OF SAME WITHOUT PERMISSION.

PROJECT REFERENCE: 040-11

MATERIAL: ABS

DRAWN BY: C. GIBBLE 7/11/11

CHECKED BY:

APPROVED BY:

TITLE: HUBBELL
 BRITISH STYLE WALL PLATE
 4-PORT, SHUTTERED

Hubbell Premise Wiring
 HUBBELL INCORPORATED (Delaware)
 14 Lord's Hill Road, Stonington, Connecticut 06378

SIZE: D
 DRAWING NO.: HWS12978C
 SCALE: 1/1

SHEET 1 OF 1

REV. 2

CATALOG NUMBER	DESCRIPTION
BPC14	4 PORT, SHUTTERED, WHITE